



CT16027JHP

Effective 4/21/2016 to 12/31/2026

AND HALF MARATHON

RUN ON THE

HAMILTON PARK 2-MILE LOOP

2-MILES (1-MILE EACH WAY)

WATERBURY, CT

MEASURED ON 4/13/2016 ALONG THE SHORTEST ROUTE WITHIN THE EDGES OF PAVED ROADS AND SIDEWALKS

ELEVATIONS: START 415-FT; SOUTH TURNAROUND (FINISH) 350-FT; NORTH TURNAROUND 320-FT; HIGHEST 430-FT; LOWEST 310-FT;

SEPARATIONS: BETWEEN START AND FINISH 980-FT;

MEASURED BY: GUIDO BROTHERS ESCORT SERVICE

pvolkmor@snet.net

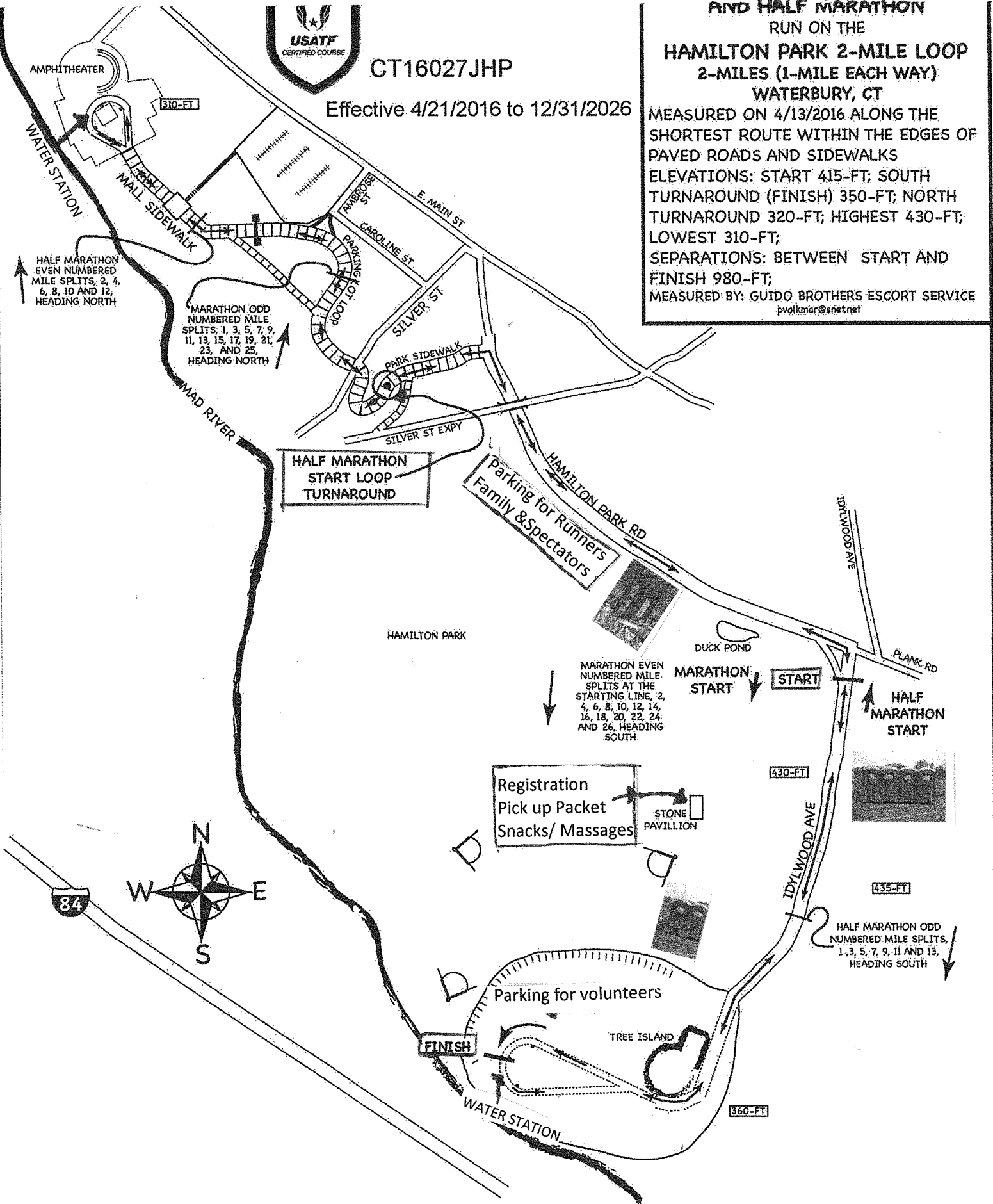

HALF MARATHON EVEN NUMBERED MILE SPLITS, 2, 4, 6, 8, 10 AND 12, HEADING NORTH

MARATHON ODD NUMBERED MILE SPLITS, 1, 3, 5, 7, 9, 11, 13, 15, 17, 19, 21, 23, AND 25, HEADING NORTH

HALF MARATHON START LOOP TURNAROUND

Parking for Runners Family & Spectators

MARATHON EVEN NUMBERED MILE SPLITS AT THE STARTING LINE, 2, 4, 6, 8, 10, 12, 14, 16, 18, 20, 22, 24, AND 26, HEADING SOUTH

Registration Pick up Packet Snacks/ Massages

MARATHON START

HALF MARATHON START

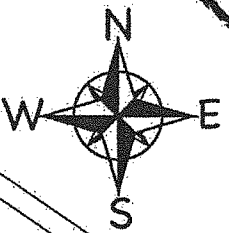

FINISH

HALF MARATHON ODD NUMBERED MILE SPLITS, 1, 3, 5, 7, 9, 11 AND 13, HEADING SOUTH

OH Boy Marathon

GBES 2016